

Ref. 8280

PORTA-PLAQUITAS PERFILADO SCMORD

SCMORD Profile Tool-Holder

Porte-Plaquettes profilage SCMORD

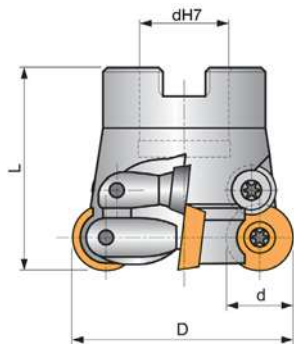

γ_p	+5°	$a_{p\ max}$	2,50 mm
γ_f	0°		3,50 mm

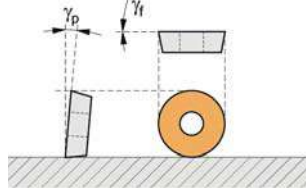

Tipo Mecanizado

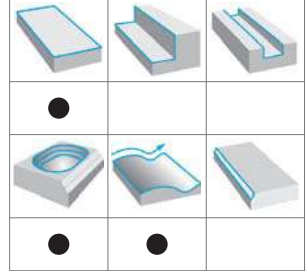

- Tornillo - Screw - Vis
- Arandela - Clamp - Rondelle
- Destornillador - Screwdriver - Tournevis

ISO	D	d	dH7	L	Z	Plaquita Insert - Plaquette	N° Art.	€			
52-SCMORD-12	52	12	22	50	5	RD..12T3	20883	305,40	Ref. 8804	Ref. 8806	Ref. 8801
66-SCMORD-12	66	12	27	50	6	RD..12T3	20885	394,43	Z-235 Art. 21011	Z-209 Art. 21368	ZT-15 Art. 10512
80-SCMORD-12	80	12	27	50	7	RD..12T3	20886	558,60	3,82 €	2,83 €	11,06 €
52-SCMORD-16	52	16	22	50	4	RD..1604	20887	305,40	Z-245 Art. 21013	Z-210 Art. 21369	ZT-20 Art. 13845
66-SCMORD-16	66	16	27	50	5	RD..1604	20891	394,43	3,41 €	2,83 €	11,06 €
80-SCMORD-16	80	16	27	50	6	RD..1604	20892	558,60			

Plaquita / Insert / Plaquette: Pag. 629



RDHW

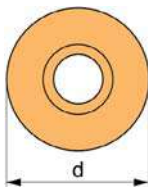

RDHT

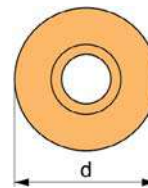
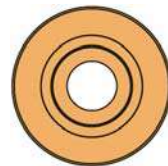
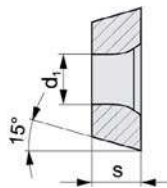

ISO	Calidades / Qualities / Qualités									Dimensiones / Dimensions		
	C-526	P-605	P-610	P-615	P-620	P-625	P-630	P-640	P-010	D	d ₁	s
RDHW 12T3MOT			●		●					12,00	3,90	3,97
RDHT 12T3MOT			●		●					12,00	3,90	3,97
RDHW 1604MOT			●		●					16,00	5,20	4,76
RDHT 1604MOT			●		●					16,00	5,20	4,76

Plaquita / Insert / Plaquette: Pag. 629

Geometría
Geometry
Géométrie

Foto
Picture
Photo

Grupo Materiales
Pieza Trabajo
Workpiece
Material Group
Groupe matériaux
pièce travail

Fresado Milling Fraisage	P	M	K	S	N	H
Acabado Finishing Finition	●	○	○	○	○	○
Desb. Medio Roug. & Finish. Semi-Finition	○	○	○	○	○	○
Desb. Grueso Coarse Rough. Ebauche	○	○	○	○	○	○

Condiciones Corte
Cutting Conditions
Conditions coupe

f_z 0,10-0,27 mm/z

Segun Dimensiones
plaquita
According to insert
dimensions
Suivant dimensions
plaquette

a_p

Geometría
Geometry
Géométrie

Foto
Picture
Photo

Grupo Materiales
Pieza Trabajo
Workpiece
Material Group
Groupe matériaux
pièce travail

Fresado Milling Fraisage	P	M	K	S	N	H
Acabado Finishing Finition	●	○	○	○	○	○
Desb. Medio Roug. & Finish. Semi-Finition	○	○	○	○	○	○
Desb. Grueso Coarse Rough. Ebauche	○	○	○	○	○	○

Condiciones Corte
Cutting Conditions
Conditions coupe

f_z 0,10-0,27 mm/z

Segun Dimensiones
plaquita
According to insert
dimensions
Suivant dimensions
plaquette

a_p

